

SPEED-0

SYNCRO RELAX AUTOMATIC MECHANISM

OPERATING INSTRUCTIONS

Seat Depth

To adjust:

While holding the backrest with your left hand press and hold the button with your right hand and move the seat to desired position using your torso.

Release button to lock in desired position.

Adjustable Arms (Width)

To adjust:

Use the lever under each arm. Push lever down to release. Adjust to desired position and pull up lever to lock in position.

Backrest Height

To raise the backrest height:
Pull backrest up; it will auto-lock at the different heights.

To lower the backrest height:
Raise backrest to full height, then lower to the lowest position and follow the above process to reach the desired height.

Adjustable Arms (Height)

To adjust height (4"):
Press and hold the button and adjust the arm to desired height. Release button to lock.

Seat Height

To raise:

Take your weight off the seat, pull the lever upwards, release the lever when the seat is at the desired height.

To lower:

Place your weight on the seat, pull the lever upwards, release the lever when the seat is at the desired height.

Backrest Lock

To lock the backrest in forwardmost position, take weight off backrest and push the lever down.

To release, pull lever up to allow backrest to return to its neutral position.

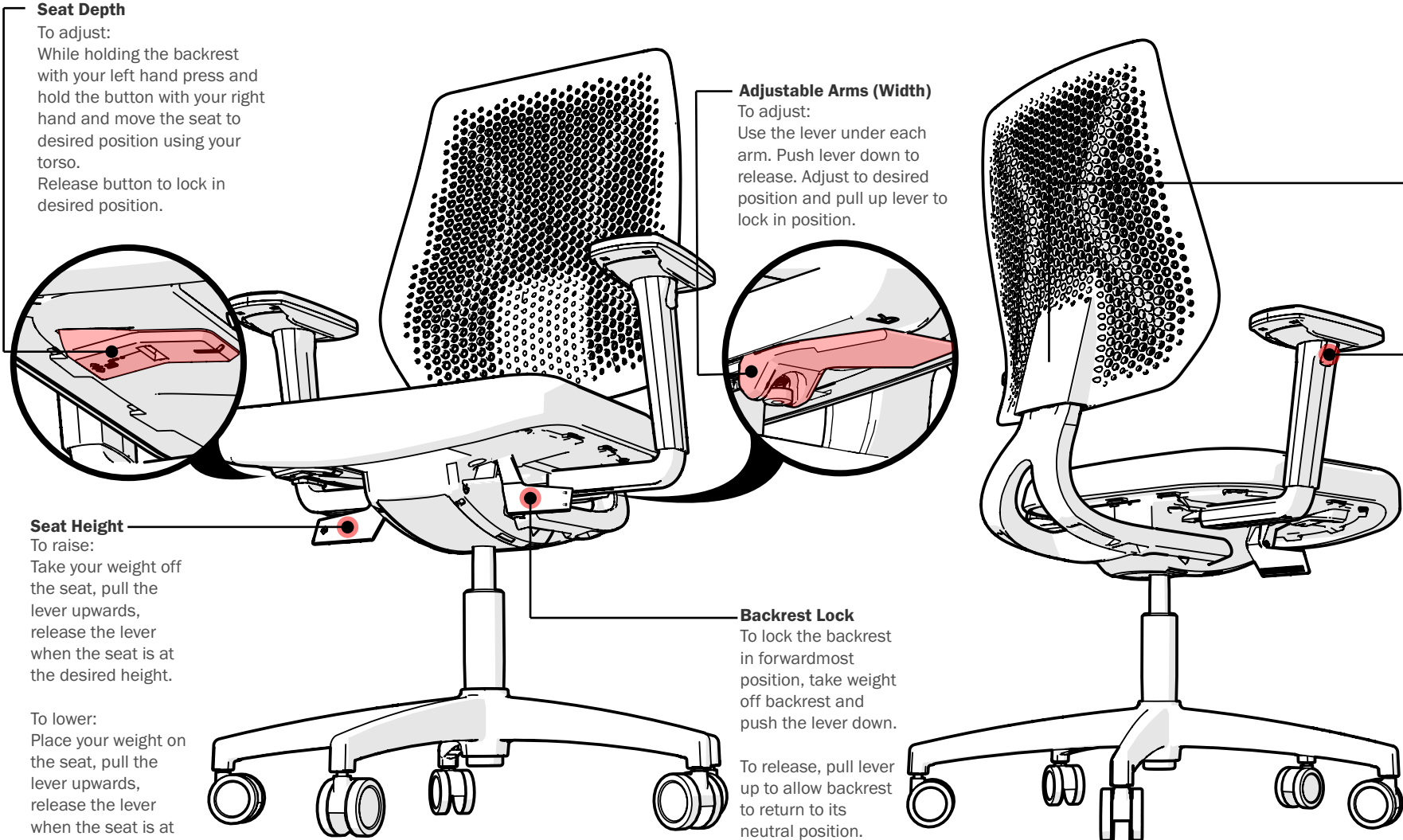

MECH: 40-0875-200

*Optional features may not be included

All specifications subject to change without notice.

Any servicing of your Dauphin chair must be performed by an authorized Dauphin dealer.